

8d box (0.113) nails @ 6" o.c. each side or equivalent.

Nail top plate to vertical plate with 3-16d (0.135) nails.

Top plate.

R-Control SIP wall.

Top plate.

Spacer material or gypsum board as req'd.

Timber.

Gypsum board.

PLAN

Scale: NTS

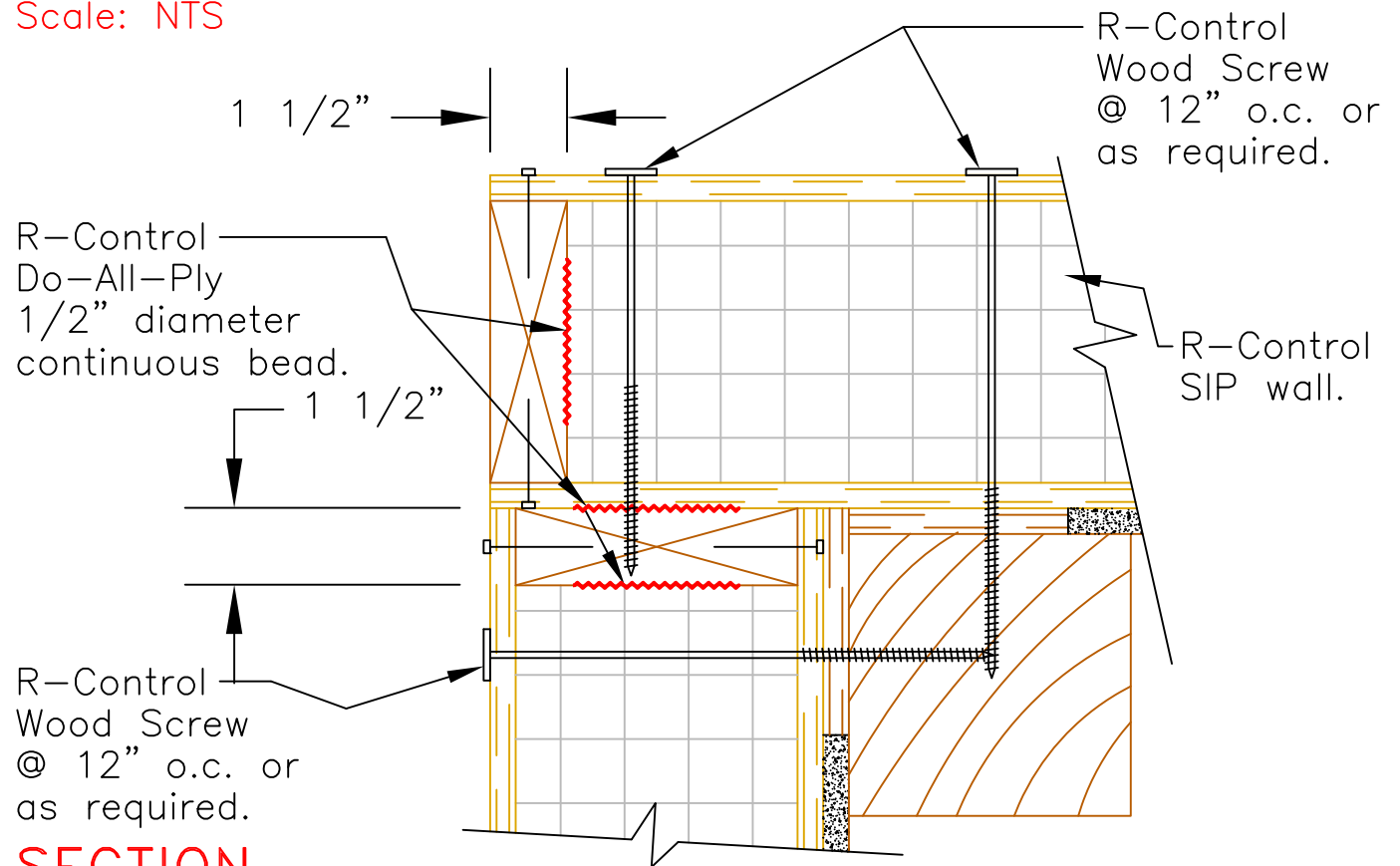

SECTION

Scale: NTS

Updated 1-16-12

R-Control® SIP

TITLE:
Corner Connection

NO.
SIP-201