

For typical cabinet loadings fasten cabinet to panels following cabinet manufacturer's recommendations.

ISOMETRIC

Scale: NTS

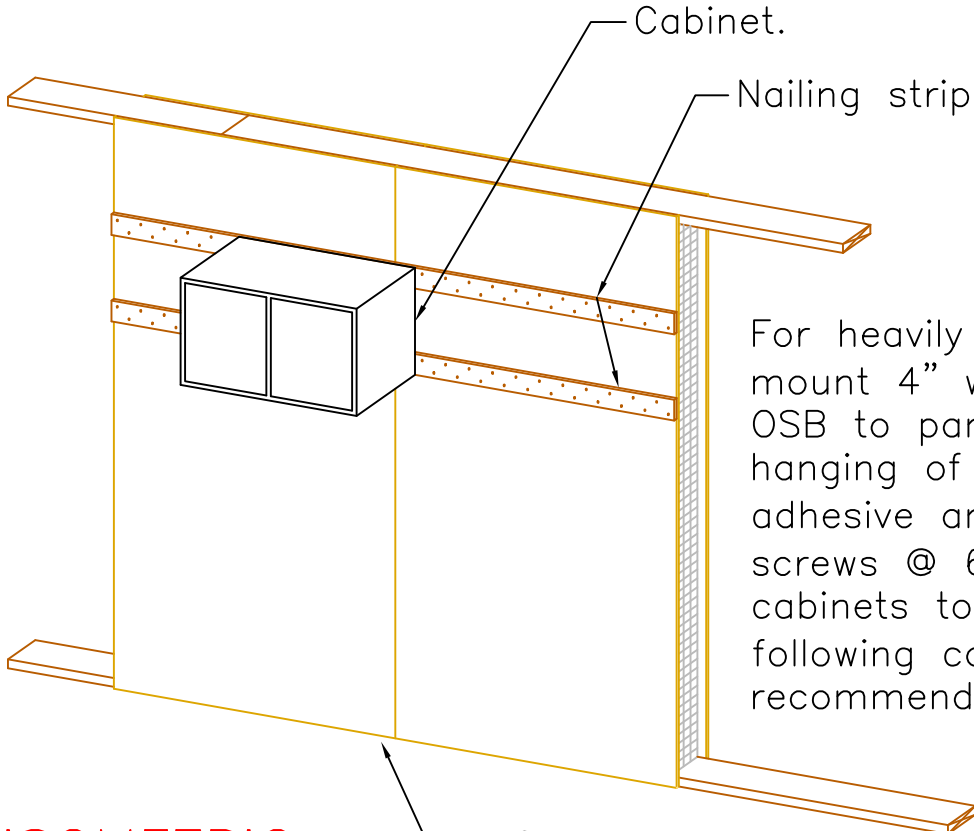

For heavily loaded cabinets mount 4" wide strips of OSB to panels prior to hanging of cabinet. Use adhesive and 2 rows of #8 screws @ 6" o.c. Fasten cabinets to nailing strips following cabinet manufacturer's recommendations.

ISOMETRIC

Scale: NTS

Updated 1-16-12

R-Control® SIP

<p>TITLE: Cabinet Attachment</p>	<p>NO. SIP-130</p>
--------------------------------------	------------------------